

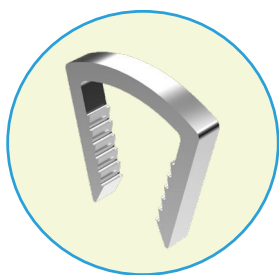

Product Information

LINKT™ Compression Staple System



Nitinol bone staples for continuous, dynamic compression during healing.



LINKT nitinol compression staples combine advanced material science with clinical performance, offering continuous, dynamic compression designed to adapt to the healing process.

The LINKT staple significantly outperformed a competitor staple in static four point bend testing*

LINKT staples are offered in a range of widths and lengths, giving surgeons the flexibility to select the optimal size for each patient's unique needs.

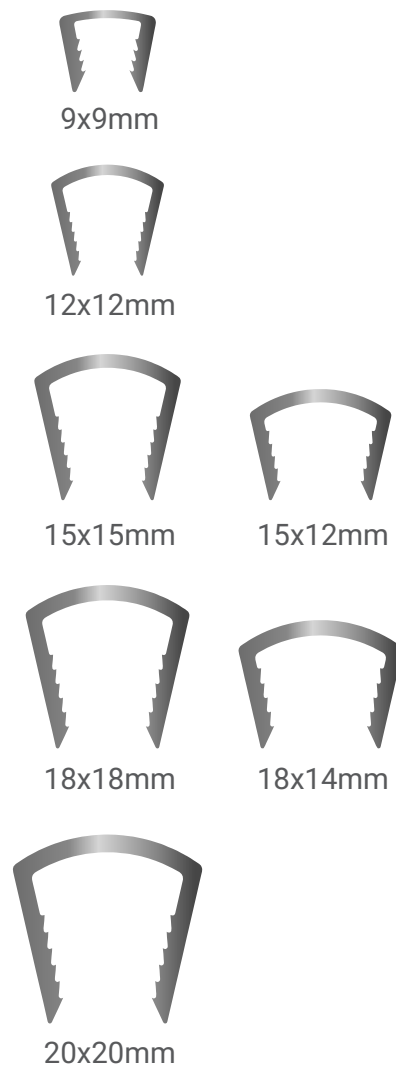
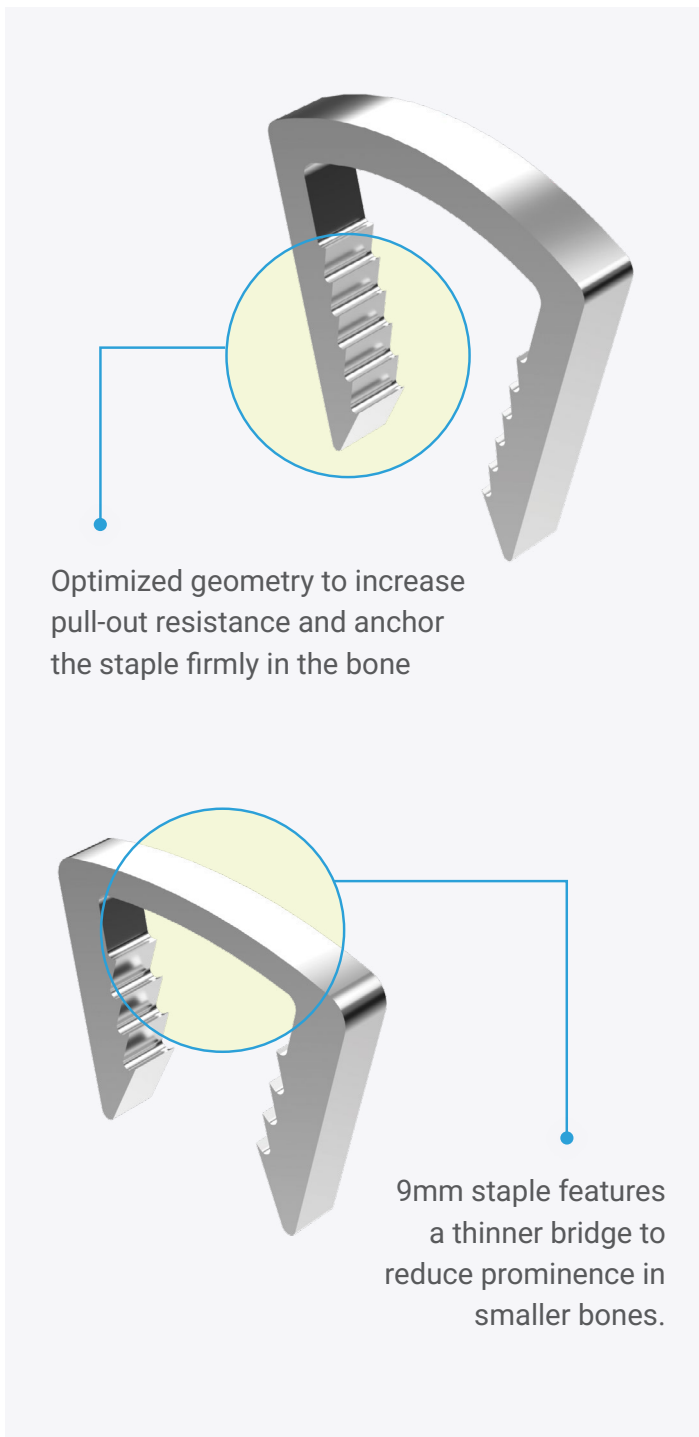



Drill Guides

Drill guides sized for each staple width.

Drills

Drills are appropriately marked for determining desired depth.



Locating Pins

Each kit contains two locating pins for convenience.



Staple Inserter

Staple inserter can deploy multiple staples and can be used to seat the staple.

Ordering Information

LINKT™ Compression Staple System

Order Number	Description	Bridge Width	Leg Length
STP0909	LINKT™ COMPRESSION STAPLE 9X9	9	9
STP1212	LINKT™ COMPRESSION STAPLE 12X12	12	12
STP1512	LINKT™ COMPRESSION STAPLE 15X12	15	12
STP1515	LINKT™ COMPRESSION STAPLE 15X15	15	15
STP1814	LINKT™ COMPRESSION STAPLE 18X14	18	14
STP1818	LINKT™ COMPRESSION STAPLE 18X18	18	18
STP2020	LINKT™ COMPRESSION STAPLE 20X20	20	20
SK09	LINKT™ STAPLE DEPLOYMENT KIT 9MM	9	9
SK12	LINKT™ STAPLE DEPLOYMENT KIT 12MM	12	12
SK15	LINKT™ STAPLE DEPLOYMENT KIT 15MM	15	12/15
SK18	LINKT™ STAPLE DEPLOYMENT KIT 18MM	18	14/18
SK20	LINKT™ STAPLE DEPLOYMENT KIT 20MM	20	20

CONTACT TRAX SURGICAL

- For questions, comments or to report an adverse event, please call Trax Customer Service at 781-436-4350.
- Instructions for Use and Surgical Technique Guide are available at www.TraxSurgical.com or contact Trax Customer Service at 781-436-4350 and these materials will be provided to you at no cost.

Trax Surgical Inc.

75 Mill Street
Stoughton, MA 02072
Tel: 781-436-4350
www.TraxSurgical.com

© 2025 Trax Surgical, Inc. All Rights Reserved. ™ and ® denote Trademarks and Registered Trademarks of Trax Surgical, Inc. For additional information please contact the manufacturer or local distributor.

P/N 77355 Rev. A 03/2026

